

REGIONAL INTEGRATED WASTE DISPOSAL FACILITY ENGINEERING DESIGN AND ENVIRONMENTAL ASSESSMENT

R.M. of Odanah, Manitoba

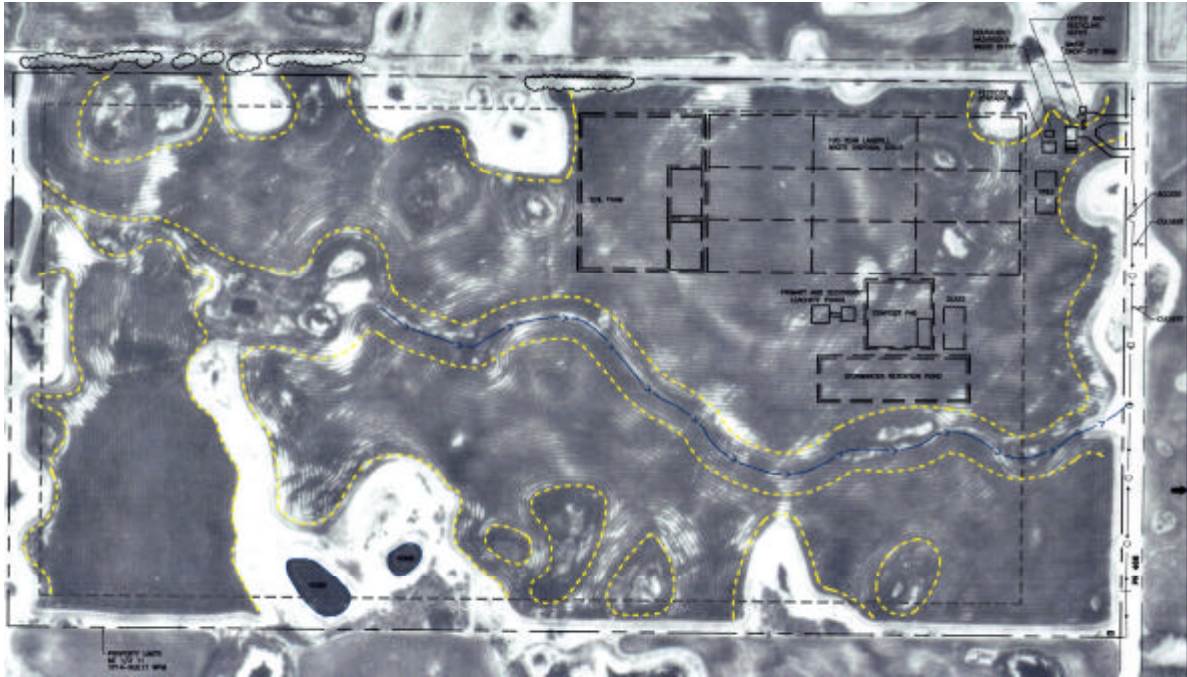

Project Description

KGS Group was retained by the project proponents, the R.M.s of Odanah, Langford, Elton, North Cypress, Minto, and Lansdowne, and the Towns of Neepawa, Minnedosa and Carberry, as engineering consultants for the proposed Neepawa Class I Regional Integrated Waste Disposal Facility (RIWDF). The RIWDF incorporates a landfill area, leachate collection system, recyclables collection area, soil remediation farm, compost facility, tire and glass storage, household hazardous waste storage, and other related services. A fast track approvals process was necessary to secure federal funding, with investigations, licensing, design and construction completed within less than 18 months.

KGS Group engineering components included; information collection on nine existing landfills, a candidate site search for the RIWDF, an investigation, assessment and design of the preferred site, evaluation of recycling and composting opportunities, a business plan development for the RIWDF, site decommissioning preliminary design and costs for nine existing landfills, obtain environmental approvals, aid in public information process, and the design, tendering and construction of the New RIWDF.

The purpose of the environmental assessment was to ensure that the proposed RIWDF was designed, constructed and operated in an environmentally responsible manner consistent with federal (*Canadian Environmental Assessment Act*) and provincial (*The Environment Act*) environmental legislation, policies and guidance to obtain the Environmental Act License. The KGS Group scope of work included identification, assessment and mitigation of adverse environmental effects of the project, evaluation of the significance of residual environmental effects, consideration of direct and indirect biophysical and socio-economic effects, including cumulative environmental effects. The need for the project, alternatives to the project and requirements for a follow-up program were considered in the assessment.